



WIN HO Technology Industrial Co.,LTD.

High Speed Precision Lathe  
Inverter Transmission Lathe



13692701 MacClis TEL: 04-24733326



V 480x1000



S 480x1000



L 560x2000



L 760x1000



L 660x3300



L 760x4300



AGENT

201309

WIN HO Technology Industrial Co., LTD.

No.7, 31<sup>st</sup> Rd, Taichung Industrial Park,  
Taichung, Taiwan, R.O.C.  
TEL: 886-4-2359-9798 FAX: 886-4-2350-0778  
E-mail: winho168@ms77.hinet.net  
<http://www.win-ho.com>



# H High Speed Precision Lathe

## Characteristics

1. Selective bed width:  
S series: 300mm.  
M series: 350mm.  
L series: 400mm.
2. Varied spindle bore diameters:  
S series: Ø58mm / Ø80mm (Option).  
M series: Ø85mm / Ø105mm (Option).  
L series: Ø85mm / Ø120mm (Option).
3. With FAG or SKF precision bearings installed on spindle, maximum cutting depth can be 8mm on 50mm diameter and best roundness 0.003mm (200mm long).
4. Equipped with plastic rear gears, shafts and gears inside headstock are well protected if crash should occur (S430 & S480 Series).
5. Thermal treated and precision ground alloy gears.
6. Universal gearbox for both imperial and metric thread-conversion table also attached.
7. Tracks of cross slide and bed are well lubricated with lubrication pump (manual).
8. Overload device to ensure safety when operating.

9. Wear-resistant phosphor bronze lead screw nuts.
10. Durable reservoir oil bath type cross slide (for S series).
11. Thermal treated Meehanite bed casting.
12. One-piece base for high rigidity and low vibration.
13. High-capacity coolant tank offers sufficient coolant output.
14. All series certified for CE. 



Reservoir Oil Bath Type Cross Slide (S series)



# S series (Bed width: 300mm)

## SPECIFICATIONS

Specifications	Model	S430 Series	S480 Series	S530 Series	M560 Series	M660 Series
		S1722,S1730,S1740, S1760,S1790	S1922,S1930,S1940, S1960,S1990	S2122,S2130,S2140, S2160,S2190	M2240,M2260 M2290	M2640,M2660 M2690
Swing Over Bed		430 mm (17")	470 mm (18-1/2")	520 mm (20-1/2")	560 mm (22")	660 mm (26")
Swing Over Cross Slide		240 mm (9-1/2")	280 mm (11")	330 mm (13")	340 mm (13-1/3")	440 mm (17-1/3")
Center Height		215mm(8-1/2")	235mm(9-1/4")	260mm(10-1/4")	280mm (11")	330mm (13")
Center Distance (mm)		560,760,1000,1500,2200 (22",30",40",60",90")	560,760,1000,1500,2200 (22",30",40",60",90")	560,760,1000,1500,2200 (22",30",40",60",90")	1000,1500,2200 (40", 60",90")	1000,1500,2200 (40", 60",90")
Swing Over Gap		650 mm (25-1/2")	690 mm (27-1/8")	740 mm (29-1/8")	788 mm (31")	890 mm (35")
Bed Width		300 mm (11-4/5")			350 mm (13-3/4")	
Spindle Nose		ASA D1 - 6 / D1 - 8 (Opt.)			ASA D1 - 8	
Spindle Bore		58 mm (2-1/4") / 80 mm (3") (Opt.)		80 mm (3")	85 mm (3-1/3")/105mm (4") (Opt.)	
Taper of Spindle Bore		MT 6 / MT 7 (Opt.)			MT 7	
Spindle Speed		20~2000 rpm (12 steps)-spindle bore:58mm/ 40~2000rpm (12 steps)-spindle bore:80mm			15~1500 rpm /14~1380rpm (12 steps)	
Inch Threads Range		4~56 TPI			2~56 TPI	
Metric Threads Range		P0.5~P7			P0.5~P14	
Longitudinal Feeds Range		0.05~0.82 mm (0.002~0.032")			0.05~0.82 mm (0.002~0.032")	
Cross Feeds Range		0.02~0.4 mm (0.001~0.0094")			0.02~0.4 mm (0.001~0.0094")	
Leadscrew Diameter		35 mm (1-1/3")			38 mm (1-1/2")	
Leadscrew Pitch		4 TPI or 6 mm			4 TPI or 6 mm	
Taper of Tail Center		MT 4			MT 5	
Tail Spindle Travel		150 mm (5-7/8")			165 mm (6-1/2")	
Tail Spindle Diameter		58 mm (2-1/4")	68 mm (2-2/3")		75 mm (2-7/8")	
Main Drive Motor		5HP (3.75KW) / 7.5HP (5.625KW. Opt.)	7.5HP (5.625KW) / 10HP (7.5KW. Opt.)		7.5HP (5.625KW) / 10HP (7.5KW. Opt.)	
Coolant Pump		1/8HP (0.1 KW)			1/8HP (0.1 KW)	
Compound Rest Travel		125 mm (4-7/8")			200 mm (7-7/8")	
Cross Slide Travel		245 mm (9-2/3")		275 mm (10-4/5")	300 mm (11-4/5")	
Machine Dimensions (cm)		L : 165,189,215,265,342 W : 81 H : 119	L : 165,189,215,265,342 W : 81 H : 122	L : 165,189,215,265,342 W : 81 H : 125	L : 229,278,353 W : 99 H : 125	L : 229,278,353 W : 99 H : 130
Packing Dimensions (cm)		L : 182,200,228,279,355 W : 95 H : 168	L : 182,200,228,279,355 W : 95 H : 168	L : 182,200,228,279,355 W : 95 H : 168	L : 238,290,361 W : 115 H : 170	L : 238,290,361 W : 115 H : 170
Net Weight (Kgs)		1500,1680,1760, 2050,2405	1540,1720,1800, 2075,2465	1580,1760,1810, 2135,2525	2200,2400,2750	2250,2450,2800
Gross Weight (Kgs)		1600,1780,1860, 2200,2555	1640,1820,1900, 2225,2615	1680,1860,1910, 2285,2675	2350,2550,2900	2400,2600,2950

\*All specifications above are subject to change without notice.

### STANDARD ACCESSORIES

- Tool Box 1 pc
- Centers 2 pcs
- Safety pin 1 pc
- Screw wrench for cutter setting 1 pc
- Back plate 1 pc
- Coolant system 1 set
- 4-way tool post 1 set
- Auto-feed stopper ring 1 set
- Center sleeve 1 pc
- Levelling pads 1 set

### OPTIONAL ACCESSORIES

- 3-jaw scroll chuck
- 4-jaw independent chuck
- Face plate
- Steady rest
- Follow rest
- Work light
- 4-position carriage stop
- Micro carriage stop
- Live centers
- Rear cutter rest
- Taper turning attachment
- Rear splash guard
- Chuck guard
- American tool post
- Change gears for D.P and module thread
- 5C lever collet closer
- Driving plate
- Quick change tool post
- Digital readout
- Hydraulic copying machine
- Chip guard
- ID/OD Grinder
- Rapid Traverse(L series)

# L series (Bed width: 400mm)

## SPECIFICATIONS

Specifications	Model	L560 Series	L660 Series	L760 Series	L830 Series
		L2240,L2260,L2280 L22100,L22120,L22160	L2640,L2660,L2680 L26100,L26120,L26160	L3040,L3060,L3080 L30100,L30120,L30160	L3340,L3360,L3380 L33100,L33120,L33160
Swing Over Bed		560 mm (22")	660 mm (26")	760 mm (30")	830 mm (33")
Swing Over Cross Slide		340 mm (13-1/3")	440 mm (17-1/3")	540 mm (21-1/4")	610 mm (24")
Center Height		280mm (11")	330mm (13")	380 mm (15")	415 mm (16")
Center Distance (mm)		1000,1500,2000,2500,3300,4300 (40",60",80",100",132",172")			
Swing Over Gap		788 mm (31")	890 mm (35")	990 mm (39")	1060 mm (42")
Bed Width		400 mm (15-3/4")			
Spindle Nose		ASA D1 - 8 / D1 - 11 (Opt.)		ASA D1 - 11	
Spindle Bore		85 mm (3-1/3") / 120 mm (4-1/2") (Opt.)		120 mm (4-1/2")	
Taper of Spindle Bore		MT 7			
Spindle Speed		15~1500 rpm (12 steps) - spindle bore:85mm / 10~1000 rpm (12 steps) - spindle bore:120mm			
Inch Threads Range		2~56TPI			
Metric Threads Range		P0.5~14			
Longitudinal Feeds Range		0.05~0.82 mm (0.002"~0.032")			
Cross Feeds Range		0.02~0.4 mm (0.001"~0.0094")			
Leadscrew Diameter		38 mm (1-1/2")			
Leadscrew Pitch		4 TPI or 6mm			
Taper of Tail Center		MT 5			
Tail Spindle Travel		165 mm (6-1/2")			
Tail Spindle Diameter		85 mm (3-1/3")			
Main Drive Motor		10HP (7.5 KW) / 15HP/6P (11 KW,Opt.)		15HP/6P (11 KW)	
Coolant Pump		1/8HP (0.1 KW)			
Compound Rest Travel		200 mm (8")			
Cross Slide Travel		375 mm (14-3/4")			
Machine Dimensions (cm)	L:	238,290,347, 398,473,555	L: 238,290,347, 398,473,555	L: 238,290,347, 398,473,555	L: 238,290,347, 398,473,555
	W:	103	103	103	103
	H:	126	131	137	141
Packing Dimensions (cm)	L:	252,300,361, 426,485,588	L: 252,300,361, 426,485,588	L: 252,300,361, 426,485,588	L: 252,300,361, 426,485,588
	W:	115	115	115	115
	H:	193	193	193	193
Net Weight		2200,2550,2900, 3150,3650,4860	2280,2630,2980, 3230,3730,4940	2360,2710,3060, 3310,3810,5020	2410,2760,3110, 3360,3860,5070
Gross Weight		2300,2650,3050, 3300,3800,5060	2380,2730,3130, 3380,3880,5140	2460,2810,3210, 3460,3960,5220	2510,2860,3260, 3510,4010,5270

\*All specifications above are subject to change without notice.

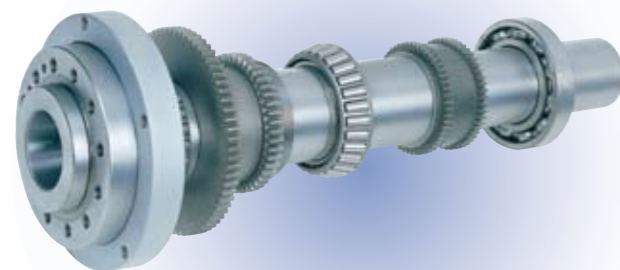

Bearings on the spindle are imported from Germany.

Varied spindle bore diameters :

- S series : Ø58mm & Ø80mm(Opt.)
- M series : Ø85mm & Ø105mm(Opt.)
- L series : Ø85mm & Ø120mm(Opt.)

Plastic gear on the rear side of headstock. (For S430 & S480 Series)



series

Inverter Transmission Lathe

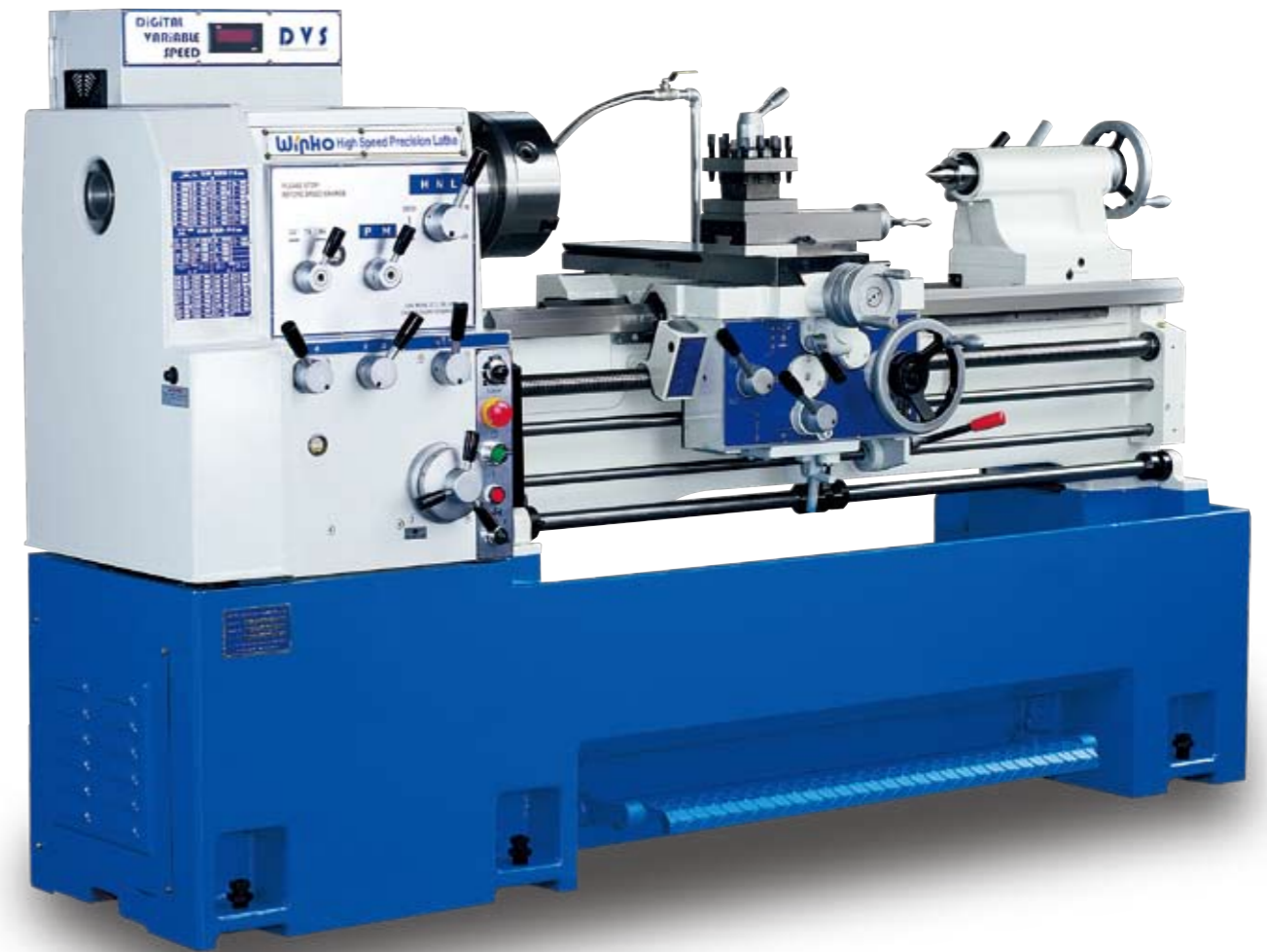

## Characteristics

1. Power-saving, stable electric current, and fine cutting trace.
2. Being controlled by a rotary switch, gear shifting is simplified.
3. Stepless speed shifting, any speed in the range is available.
4. Cutting depth reaches 8mm(at 1000rpm).



# V series (Inverter Transmission Lathe) (Bed width: 300mm)

## SPECIFICATIONS

Specifications	Model	V430 Series	V480 Series	V530 Series
		V1722,V1730,V1740,V1760,V1790	V1922,V1930,V1940,V1960,V1990	V2122,V2130,V2140,V2160,V2190
Swing Over Bed		430 mm (17")	470 mm (18-1/2")	520 mm (20-1/2")
Swing Over Cross Slide		240 mm (9-1/2")	280 mm (11")	330 mm (13")
Center Height		215mm(8-1/2")	235mm(9-1/4")	260mm(10-1/4")
Center Distance (mm)		560,760,1000,1500,2200 (22",30",40",60",90")	560,760,1000,1500,2200 (22",30",40",60",90")	560,760,1000,1500,2200 (22",30",40",60",90")
Swing Over Gap		650 mm (25-1/2")	690 mm (27-1/8")	740 mm (29-1/8")
Bed Width		300 mm (11-4/5")		
Spindle Nose		ASA D1 - 6 / D1 - 8 (Opt.)		ASA D1 - 8
Spindle Bore		58 mm (2-1/4") / 80 mm (3") (Opt.)		80 mm (3")
Taper of Spindle Bore		MT 6 / MT 7 (Opt.)		
Spindle Speed		20~2000 rpm (stepless)		
Inch Threads Range		4~56 TPI		
Metric Threads Range		P0.5~P7		
Longitudinal Feeds Range		0.05~0.82 mm (0.002~0.032")		
Cross Feeds Range		0.02~0.4 mm (0.001~0.0094")		
Leadscrew Diameter		35 mm (1-1/3")		
Leadscrew Pitch		4 TPI or 6 mm		
Taper of Tail Center		MT 4		
Tail Spindle Travel		150 mm (5-7/8")		
Tail Spindle Diameter		58 mm (2-1/4")	68 mm (2-2/3")	
Main Drive Motor		7.5HP (5.625KW)		
Coolant Pump		1/8HP (0.1 KW)		
Compound Rest Travel		125 mm (4-7/8")		
Cross Slide Travel		245 mm (9-2/3")		275 mm (10-4/5")
Machine Dimensions (cm)	L : 165,189,215,265,342	L : 165,189,215,265,342		L : 165,189,215,265,342
	W : 81	W : 81		W : 81
	H : 119	H : 122		H : 125
Packing Dimensions (cm)	L : 182,200,228,279,355	L : 182,200,228,279,355		L : 182,200,228,279,355
	W : 95	W : 95		W : 95
	H : 168	H : 168		H : 168
Net Weight (Kgs)	1500,1680,1760,2050,2405	1540,1720,1800, 2075,2465	1580,1760,1810,2135,2525	
Gross Weight (Kgs)	1600,1780,1860,2200,2555	1640,1820,1900, 2225,2615	1680,1860,1910,2285,2675	

\*All specifications above are subject to change without notice.

### STANDARD ACCESSORIES

■ Tool Box	1 pc
■ Centers	2 pcs
■ Safety pin	1 pc
■ Screw wrench for cutter setting	1 pc
■ Back plate	1 pc
■ Coolant system	1 set
■ 4-way tool post	1 set
■ Auto-feed stopper ring	1 set
■ Center sleeve	1 pc
■ Levelling pads	1 set

### OPTIONAL ACCESSORIES

■ 3-jaw scroll chuck	■ Chuck guard
■ 4-jaw independent chuck	■ American tool post
■ Face plate	■ Change gears for D.P. and module thread
■ Steady rest	■ 5C lever collet closer
■ Follow rest	■ Driving plate
■ Work light	■ Quick change tool post
■ 4-position carriage stop	■ Digital readout
■ Micro carriage stop	■ Hydraulic copying machine
■ Live centers	■ Chip guard
■ Rear cutter rest	■ ID/OD Grinder
■ Taper turning attachment	
■ Rear splash guard	

### OPTIONAL ACCESSORIES

- Change Gears for D.P. and Module Thread
- Taper Turning Attachment
- Steady Rest
- Follow Rest
- Chip Guard
- Chuck Guard
- Quick Change Tool Post
- American Tool Post
- Rear Cutter Rest
- 4-position Carriage Stop
- Micro Carriage Stop
- Rear Splash Guard
- Work Light
- 5C Lever Collet Closer
- Live Center with Replaceable Inserts
- Face Plate
- Driving Plate
- Rapid Traverse
- Hydraulic Copying Machine
- Digital Readout
- ID/OD Grinder